

PUSH BUTTON SWITCHES FOR MODERN ELECTRONIC APPLICATIONS.

HIGHLY PROFESSIONAL, RELIABLE, SLEEK AND VERSATILE.

SWITCHES ARE MODULAR CONSTRUCTION AND HAVE DOUBLE THROW SWITCHING ACTION.

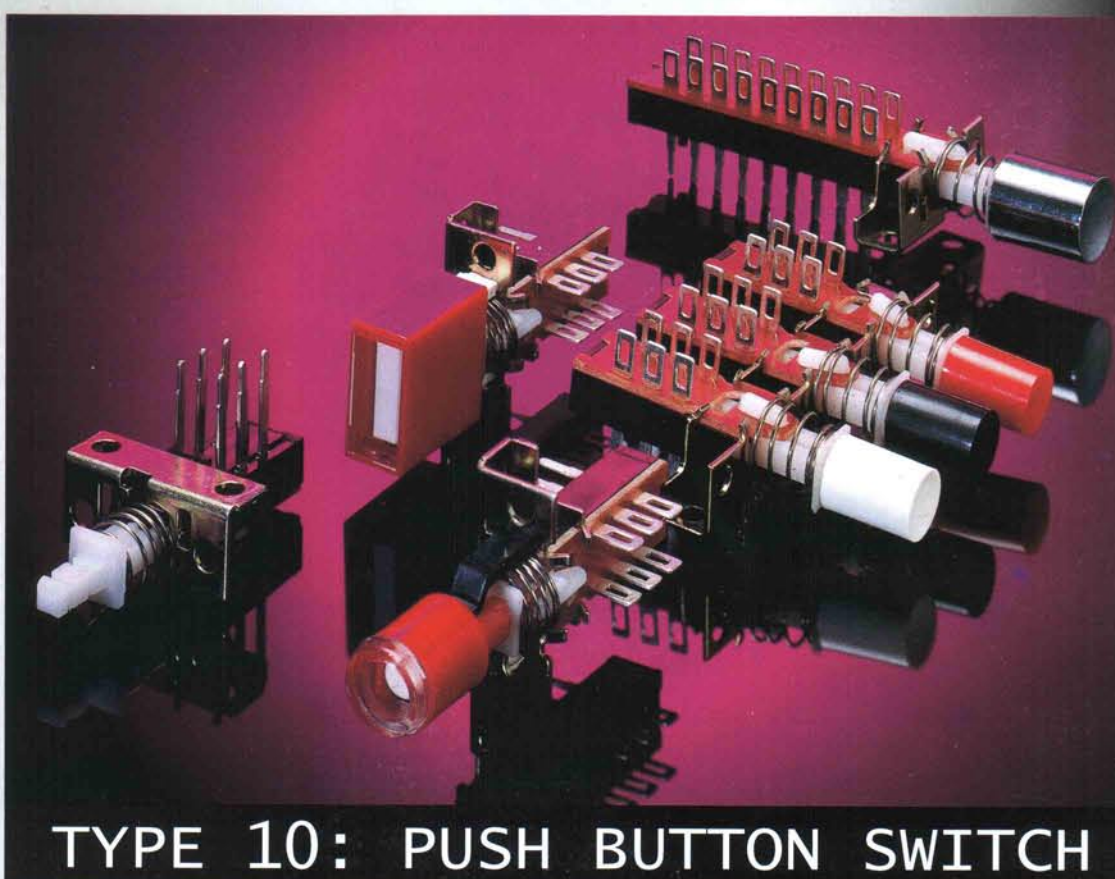

TYPE 10: PUSH BUTTON SWITCH

SPECIFICATIONS:

SIZE	: 2, 4, 6 POLE, SINGLE AND CHASSIS ASSEMBLIES OF 2 TO 13 STATIONS
FUNCTION	: PUSH PUSH (PP), MOMENTARY (MC), INTERLOCKING (IL), CENTRAL RELEASE (CR)
CONTACTS	: DOUBLE THROW, NON SHORTING, BREAK BEFORE MAKE
RATING	: 1 A, 25 V DC OR 0.2 A, 230 V AC
CONTACT RESISTANCE	: 10 mΩ MAX. INITIAL, 50 mΩ MAX AFTER 25,000 CYCLES AT RATED LOAD
PROOF VOLTAGE	: 1500 V AC FOR 1 MIN. AT 50 HZ
INSULATION RESISTANCE	: $1 \times 10^{10} \Omega$
OPERATING LIFE	: 25,000 CYCLES AT RATED LOAD
STANDARD VERSION	: TERMINAL - FTL, TERMINAL BOARD - PAPER PHENOLIC, WITH OR WITHOUT MOUNTING BRACKET - 18 X 3.2 Ø
OPTIONS	: TERMINALS - STL, PTL, BPTL, LPTL MOUNTING BRACKETS : 18 X 2.4, 20 X 3.2 Ø, 20 X M3
KNOB COLOURS	: PLATED, BLACK, WHITE, GREY, YELLOW, GREEN, BLUE, RED



MEHTA SWITCH

SWITCH CODE

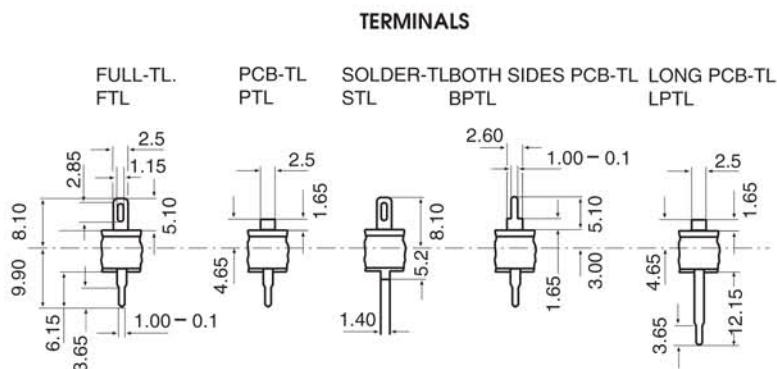
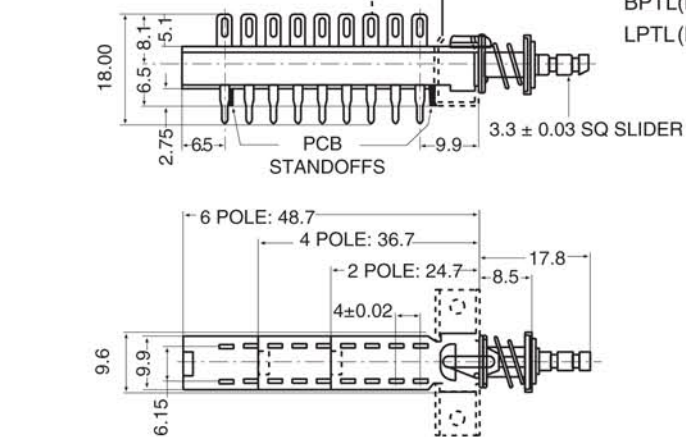
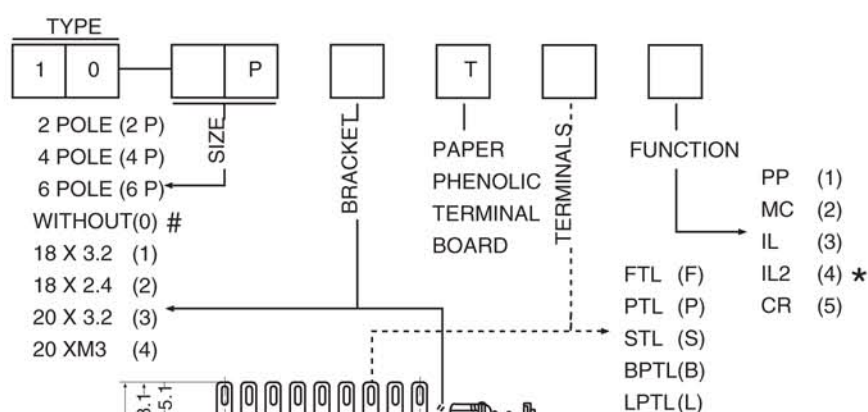

STANDARD MOUNTING BRACKET

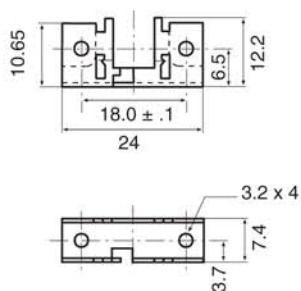

ROUND KNOBS AVAILABLE

KNOB CODE

8.5 mm DIA.

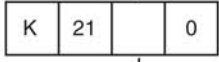

11.5 mm DIA.

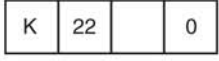

COLOUR	CODE
PLATED	(1)
BLACK	(2)
WHITE	(3)
GREY	(4)
YELLOW	(5)
GREEN	(6)
BLUE	(7)
RED	(9)

CHASSIS ASSEMBLY CODE

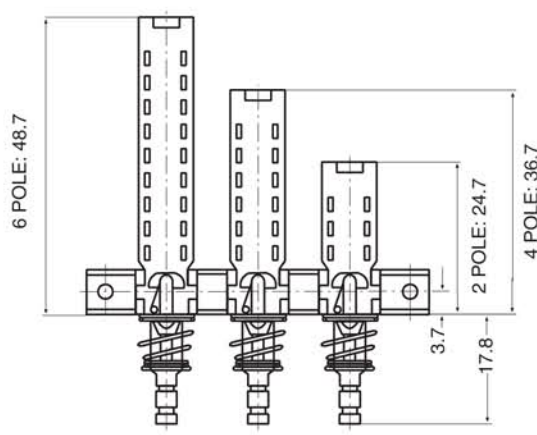
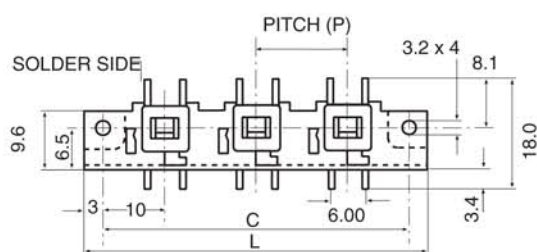
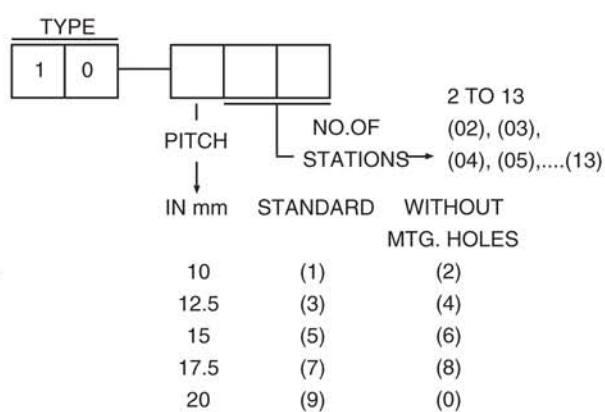

STATION NO. → 1 2 3 → up to 13
LEFT TO RIGHT LOOKING TOWARDS BUTTON AND SWITCH WITH SOLDER SIDE UP

C

STATIONS / PITCH (P)	2	3	4	5	6	7	8	9	10	11	12	13
10	30	40	50	60	70	80	90	100	110	120	130	140
12.5	32.5	45	57.5	70	82.5	95	107.5	120	132.5	-	-	-
15	35	50	65	80	95	110	125	140	-	-	-	-
17.5	37.5	56	72.5	90	107.5	125	142.5	-	-	-	-	-
20	40	60	80	100	120	-	-	-	-	-	-	-

- LONGER CHASSIS ALSO AVAILABLE
- * ■ FOR MORE THAN 1 INDEPENDENT INTERLOCKING (IL)
 - INCASE OF 10 mm SPACING, PROVIDE 1 EMPTY STATION AFTER EACH INDEPENDENT (IL) GROUP
- # ■ WITHOUT MOUNTING BRACKETS ARE MODULES
 - CHASSIS ASSEMBLIES: BESIDES CHASSIS CODE SPECIFY REQUIRED MODULE AND KNOB CODES AT EACH STATION
- ALL DIMENSIONS IN mm, TOLERANCE ± 0.2 mm
- ALL CODES ARE GIVEN IN THE BRACKETS ()